

REPLACEMENT FLOAT VALVE KIT INSTRUCTIONS

Note: Before replacing the float valve, turn off the water supply to the softener by pushing the stem on the bypass valve in for bypass. Unplug transformer from electrical power.

1. Remove salt hole cover.
2. Slide top cover forward exposing nozzle and venturi assembly.
3. Loosen the nut ferrule and remove brine line from the end of the nozzle and venturi assembly (**Figure 1**).
4. Remove brinewell cover from brinewell (**Figure 2**).
5. Grasp the brine line coming out of the brinewell and lift up.
6. Remove float valve from brinewell and lower new float valve into brinewell. Secure brine line in slot on brinewell with the float assembly resting on the bottom of the salt storage tank (**Figures 2 and 3**).
7. Run the brine line on the new float valve through the salt tank and attach the brine line with nut ferrule to nozzle and venturi assembly (**Figure 1**).
8. Hand tighten nut ferrule onto the end of the nozzle and venturi assembly (**Figure 1**).
9. Replace all covers.
10. Slowly move the bypass valve stem towards the soft water position.
11. Plug the transformer into the electrical outlet.
12. To verify proper function of the softener, complete the manual advance diagnostics as outlined in the **Installation/Operation manual**.

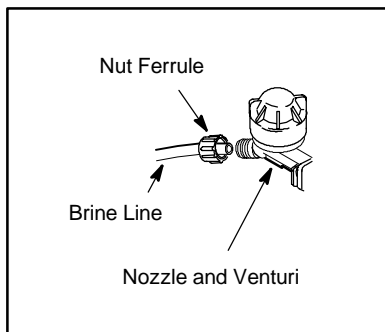

Figure 1

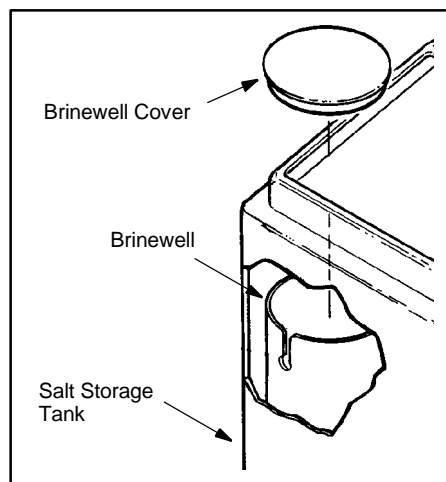

Figure 2

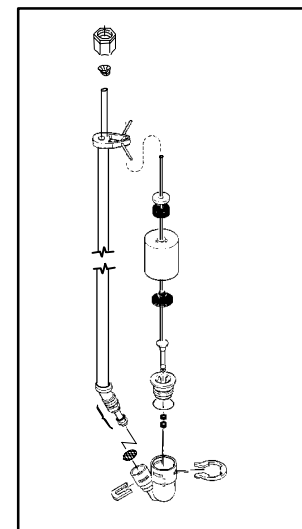

Figure 3