

REPLACEMENT RESIN TANK ASSEMBLY INSTALLATION INSTRUCTIONS

Note: Before attempting to replace the resin tank, close the shut off valve on the house main water line, near the water meter or pressure tank. Open a nearby conditioned water faucet to vent pressure from the unit. Unplug the transformer from electrical power.

1. Push the bypass valve stem in for bypass. **Figure 1.**
2. Remove the salt hole cover and set aside.
3. Slide the top cover forward to expose valve.
4. Carefully disconnect wiring harness from position switch. **Figure 2.**
5. Carefully unplug the motor terminals from the back of the electronic control board. **Figure 2.**
6. Set top cover aside.
7. Carefully remove the large retainer clips on the softener inlet and outlet. Separate the water softener from the bypass valve.
8. Using a needle nose pliers, lift up on drain clip and remove valve drain hose adapter from valve. Set aside. **Figure 3.**
9. Disconnect brine line from nozzle and venturi assembly by loosening the nut ferrule.
10. Remove retainer clips and clamps from around the tank neck. Set aside. **Figure 4.**
11. Remove valve from resin tank and set aside. **Figure 4.**
12. Remove vapor barrier and locking plate to remove tank. Carefully lift resin tank out of salt storage tank and replace with new resin tank. Remove shipping cap by removing clips and clamp sections from around tank neck.
13. Once tank is in position, replace vapor barrier and locking plate and lock into salt storage tank.
14. With all o-rings (lubricated with silicone grease) and the top distributor in place in the top of the tank, check the riser pipe length. It should be about even with the top edge of the top distributor. **Figure 4.**
15. Be sure all parts are clean and free of resin beads and other debris, including the bottom of the valve assembly. Lightly lubricate with silicone grease the o-ring sealing surface in the inside of the valve port, at the bottom of the valve. **Figure 4.**
16. Locate the distributor o-ring at the very top of the riser pipe as shown in **Figure 4.** DO NOT SLIDE IT DOWN TO REST AGAINST THE TOP DISTRIBUTOR.
17. Carefully lower the valve assembly onto the tank, aligning it with the riser pipe, and work over the o-ring and onto the adaptor. Then clamp in place. **Figure 4.**
18. Carefully reconnect the water softener valve inlet and outlet back together with the bypass valve. Attach with large retainer clips.
19. Reconnect brine line to nozzle and venturi assembly by hand-tightening the nut ferrule. **Figure 5.**
20. Reconnect valve drain adaptor to valve and secure with drain clip. **Figure 3.**
21. Carefully reconnect the motor terminals to the back of the electronic control board. Reattach the wire harness onto the position switch. **Figure 2.**

22. Fully open the house main water supply valve. Observe a steady flow of water with no air bubbles.
23. SLOWLY MOVE THE BYPASS VALVE STEM TOWARD THE SOFT WATER POSITION, PAUSING SEVERAL TIMES TO ALLOW UNIT TO PRESSURIZE. **Figure 1.**
24. After about three minutes, open a hot water faucet for about one minute, or until all air is expelled, then close.
25. Close all cold water faucets and check your plumbing connections for leaks.
26. Plug transformer into electrical outlet.
27. To verify proper function of the softener, complete the manual advance diagnostics as outlined in the **Installation/Operation manual.**

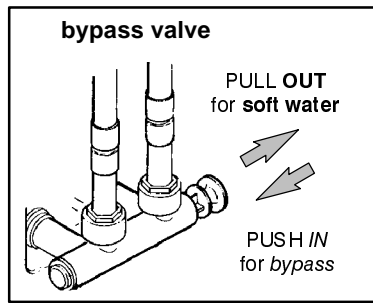

Figure 1

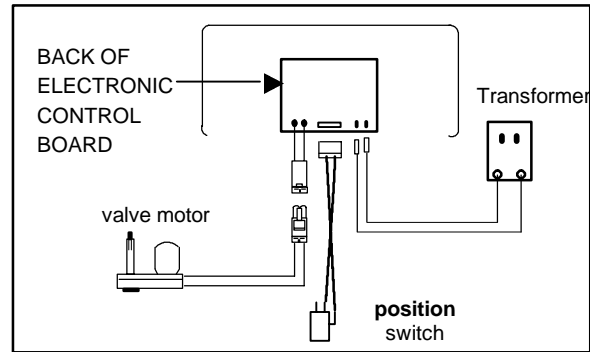

Figure 2

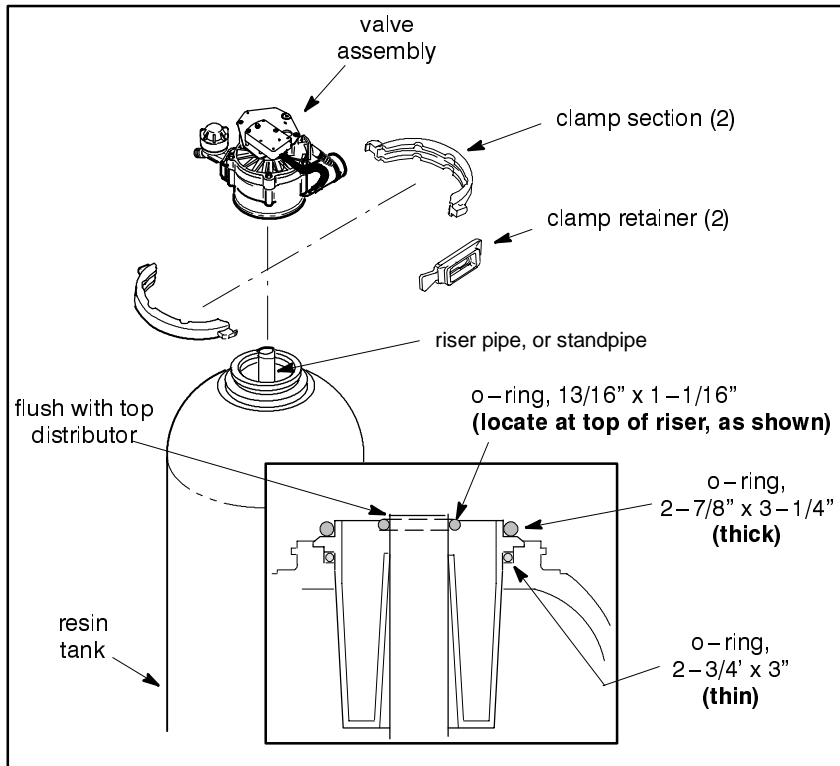

Figure 4

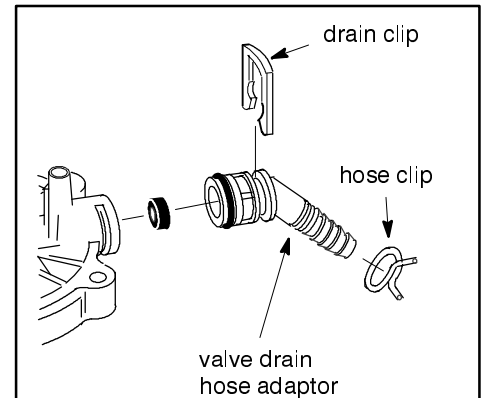

Figure 3

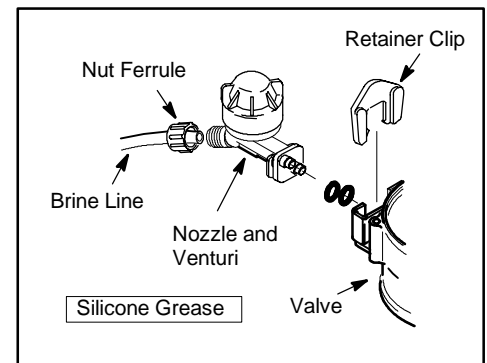

Figure 5